

Floor Plans: Upper and Lower Galleries (not to scale)
 Stone School Gallery, Portage-du-Fort.

- Hanging is done using chain and hooks (supplied by gallery) so works must have a wire across the back.
- White wooden display plinths are available in various sizes:
 2 (23x23"), 2 (12x12"), 2 (12x 17"), 1 (10x10"), 1 (15 x17")
- Hooks or nails cannot be put into the plaster walls

LOWER GALLERY: 69 feet of wall space with 10' ceilings

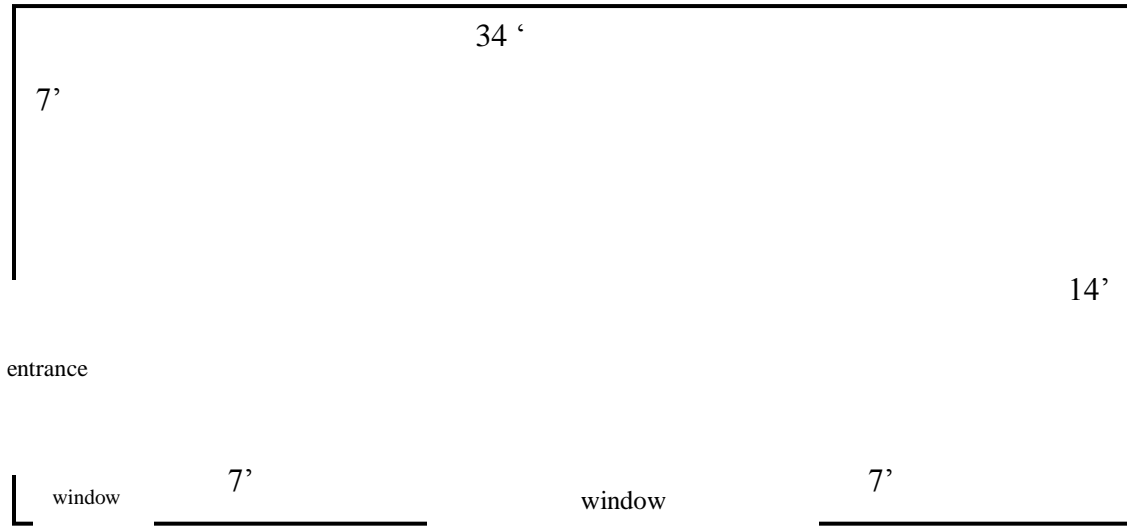

UPPER GALLERY: 80 feet of wall space with 12' ceilings

